



Level

G

Information & Amenities

	Blue Lifts
	Gold Lifts
	Purple Lifts

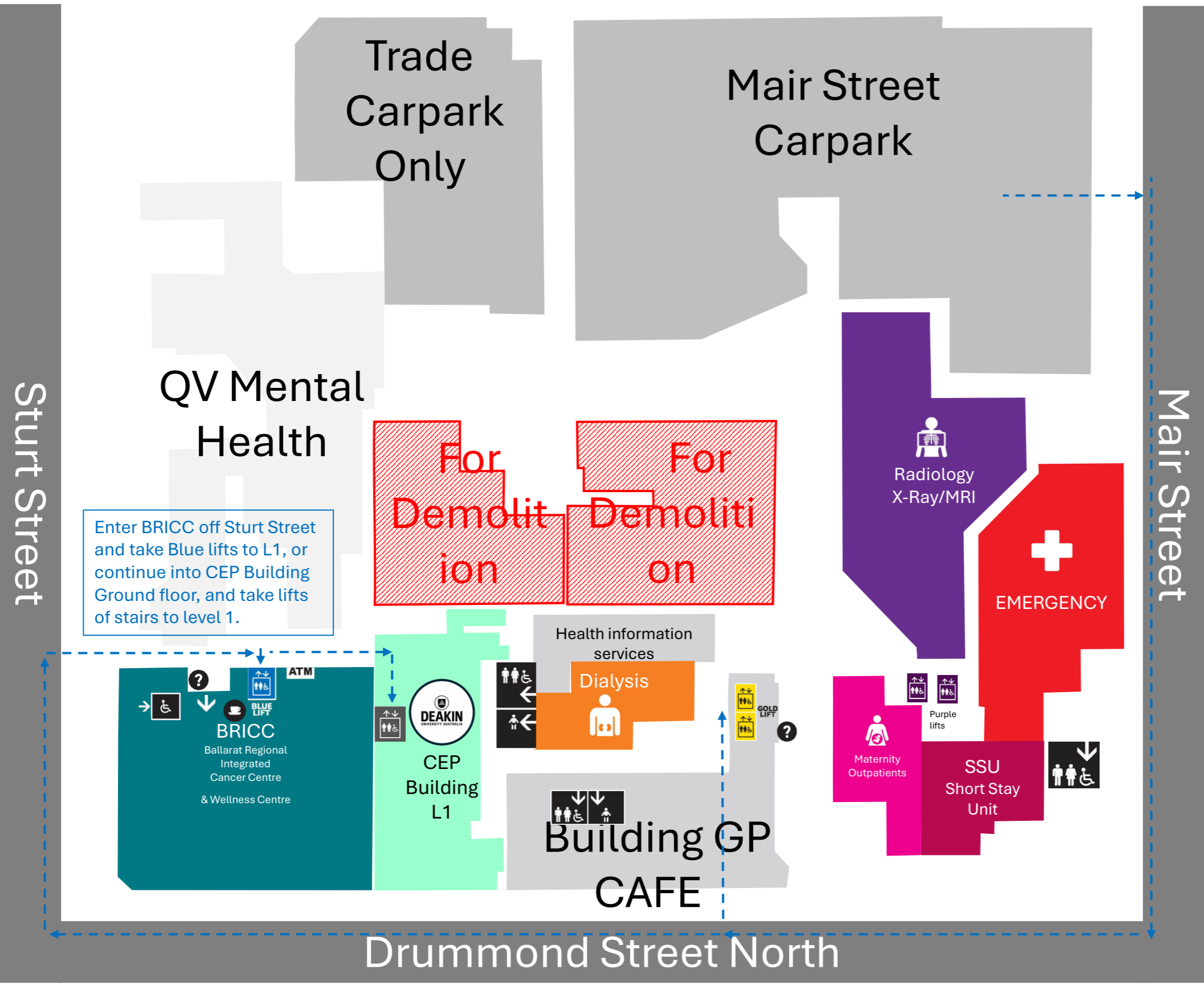

Enter BRICC off Sturt Street and take Blue lifts to L1, or continue into CEP Building Ground floor, and take lifts of stairs to level 1.

Enter Café off Drummond St Nth through revolving doors, proceed straight ahead. Take Gold lifts to L1



Level

1

Information & Amenities

- ? Information
- Public Toilets
- Parent Room / Baby Change / Feed
- Coffee / Tea Room

Sturt Street

Mair Street

Drummond Street North

Follow the circulation space up ramp, and into CEP building.

Follow circulation space through Sloss House and into CEP building.

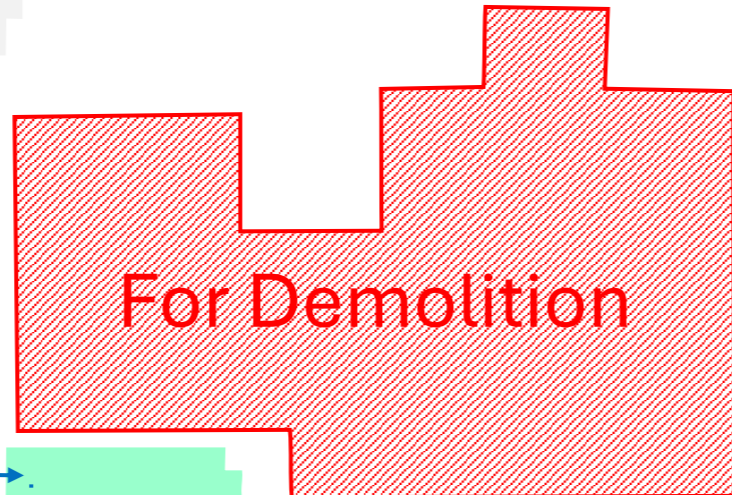

**BRICC**  
Ballarat Regional Integrated Cancer Centre & Wellness Centre

BLUE LIFT

**CEP Building L1**

DEAKIN UNIVERSITY AUSTRALIA

Diagnostic services

GOLD LIFT

?

Cardiovascular Suite

DPU Day Procedure Unit

ICU Intensive Care Unit

CCU Coronary Care Unit

Theatre



Level

1

Information & Amenities

- Information
- Public Toilets
- Parent Room / Baby Change / Feed
- Coffee / Tea Room

